

MRSA Specimen Collection Protocol

for use with Xpert™ MRSA

Xpert™ MRSA

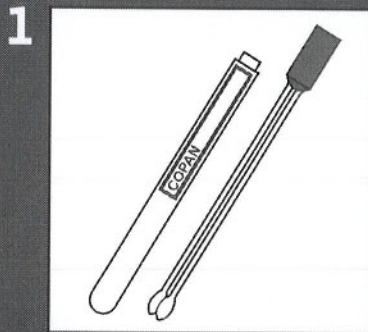

A Copan Venturi Transystem double swab must be used to collect the specimen.
Cepheid Collection Device #900-0370

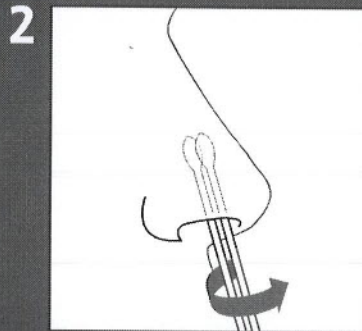

Insert the dry swabs 1-2cm into the nostril and rotate swabs against the inside of the nostril for 3 seconds while applying pressure with a finger to the outside of the nose.

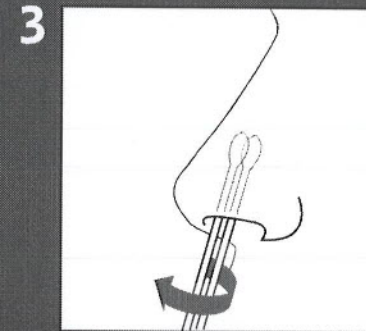

Repeat Step 2 in second nostril.

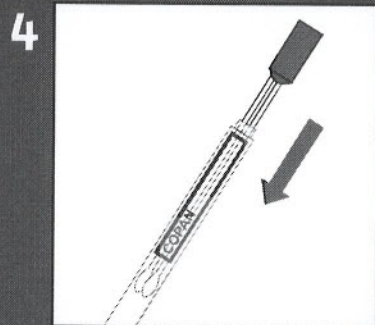

Place the swabs back into the tube.

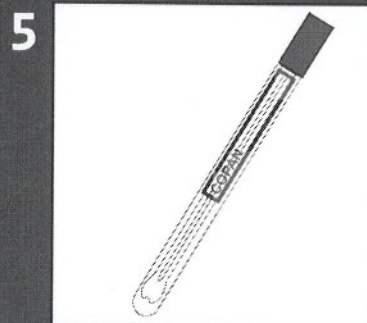

Specimens that can be tested within 24 hours can be kept at room temperature; if not, it is recommended that they be refrigerated. Specimens stored at 2-8°C are stable for up to 5 days.

defining *on-demand* molecular diagnostics.

For Technical Assistance please contact: Cepheid Technical Support: 888-838-3222, Option 2

 **Cepheid**
Bring answers to life.